

NOTES:
 PARAPETRALING OPEN FROM ALL SIDES FOR NATURAL VENTILATION.

- ALL PIPE DIAMETERS ARE IN MM
- ALL CONNECTIONS FLOOR DRAIN TO FLOOR TRAP WILL BE 63.00 UPVC WASTE PIPE
- ALL WASTE FROM WASH BASIN TO FT WILL BE 40.00 UPVC WASTE PIPE
- ALL WASTE FROM URINALS TO UT WILL BE 50.00 UPVC 50MM UPVC
- ALL PIPES FROM FT TO STACK WILL BE 110.00 UPVC PIPES OR OTHERWISE PREPARED
- ALL PIPES FROM WC/UT TO STACK WILL BE 110.00 UPVC PIPES OR OTHERWISE PREPARED

PIPE DIAMS

S.NO.	SYMBOL	DESCRIPTION
1	WB	110.00
2	UP	110.00
3	FD	110.00
4	FT	110.00
5	WC	110.00

Note:

1. BUILDING HAS AUTOMATIC SPRINKLER SYSTEM AS PER NBC CODE REQUIREMENT
2. BUILDING WILL BE DESIGNED (STRUCTURES) AS PER RELEVANT IS CODES FOR EARTH QUAKE RESISTANCE
3. BUILDING IS ARTIFICIALLY LIGHTED MECHANICALLY VENTILATED & CENTRALLY AIR-CONDITIONED WITH POWER BACKUP

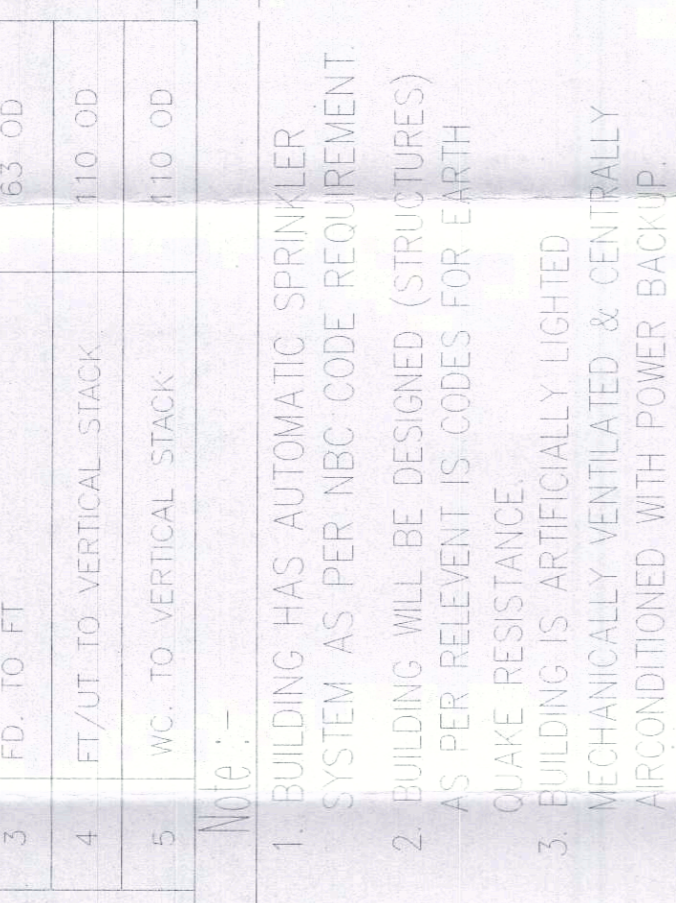

LEGEND FOR PLUMBING:

S.NO.	SYMBOL	DESCRIPTION
01	○	110.00 SOIL PIPE
02	○	110.00 WASTE PIPE
03	○	75.00 ANTI-SIPHONAGE PIPE
04	○	DOMESTIC WATER SUPPLY THROUGH AUTOMATIC
05	○	DOMESTIC WATER SUPPLY THROUGH AUTOMATIC
06	○	FLUSHING WATER SUPPLY THROUGH AUTOMATIC
07	○	110.00 TERRACE RAIN WATER PIPE
08	○	110.00 MOUNTAIN/BALCONY RAIN WATER
09	○	FLOOR DRAIN
10	○	FLOOR TRAP
11	○	URINAL TRAP
12	○	CLEAN OUT / DUG
13	○	SOIL PIPE
14	○	WASTE PIPE
15	○	UPVC PIPE
16	○	RAIN WATER PIPE
17	○	DOMESTIC WATER PIPE
18	○	CUSTOMER WATER PIPE

DOOR WINDOW SCHEDULE

S.NO.	LEGEND	WIDTH (mm)	HEIGHT (mm)	CELL LINE LEVEL	REMARKS	LOCATION	FIRE RATING
1	D1	800	2100	0	WOODEN DOOR	TOILET CUBICULUM	
2	D2	900	2000	100	WOODEN DOOR	PAINTER ROOM	
3	D3	1050	2100	0	WOODEN DOOR	HT TOILET	
4	D04	1000	2400	0	WOODEN DOOR	TOILET CUBICULUM	
5	D06	1050	2100	0	WOODEN DOOR	HT TOILET	
6	D06	1050	2100	0	WOODEN DOOR	HT TOILET	
7	D06	1050	2100	0	WOODEN DOOR	HT TOILET	
8	D4	2000	2400	0	WOODEN DOOR	HT TOILET	
9	D4	2000	2400	0	WOODEN DOOR	HT TOILET	
10	D7	1300	2400	0	WOODEN DOOR	HT TOILET	
11	D7	1300	2400	0	WOODEN DOOR	HT TOILET	
12	D8	2000	2400	0	WOODEN DOOR	HT TOILET	
13	D10	3000	2400	0	WOODEN DOOR	HT TOILET	
14	D11	1050	2400	0	WOODEN DOOR	HT TOILET	
15	FC1	900	2000	0	WOODEN DOOR	HT TOILET	
16	FC1	900	2000	0	WOODEN DOOR	HT TOILET	
17	AD	750	2000	100	WOODEN DOOR	HT TOILET	
18	AD	750	2000	100	WOODEN DOOR	HT TOILET	
19	FD1	2000	2400	0	METAL FIRE DOOR	HT TOILET	2-HOUR FIRE RATED DOOR
20	FD2	1600	2400	0	METAL FIRE DOOR	HT TOILET	2-HOUR FIRE RATED DOOR
21	FD26	1600	2100	0	METAL FIRE DOOR	HT TOILET	2-HOUR FIRE RATED DOOR

Architects:
 Arcop Associates Pvt. Ltd.
 Plot- 36b, Sec-32, Gurgaon-122001
 Ph: +91-124-4955500
 Fax: +91-124-4955500
 Monteddi, Toronto, New-Delhi, Boston

PROPOSED REVISION BUILDING PLAN OF COMMERCIAL COLONY AREA MEASURING 32.36 ACRES PART OF RESIDENTIAL PLOTTED COLONY NAMELY DLF CITY PHASE III AND INDEPENDENT COMMERCIAL COLONY 4.00 ACRES (LICENCE NO.59 OF 2018 DATED 07.09.2018) BY MAKING TOTAL AREA MEASURING 36.36 ACRES UNDER T00 ZONE IN SECTOR 24 & 26A GURIGRAM MANESAR URBAN COMPLEX BEING DEVELOPED BY DLF LIMITED AND OTHERS.

DRAWING TITLE: MLCP TERRACE FLOOR PLAN
DATE: 15-04-2021
SCALE: 1:150
PROJECT NO.: DTN/MLCP/04
ARCHITECTS: VIKRAM MANFREET & ASSOCIATES

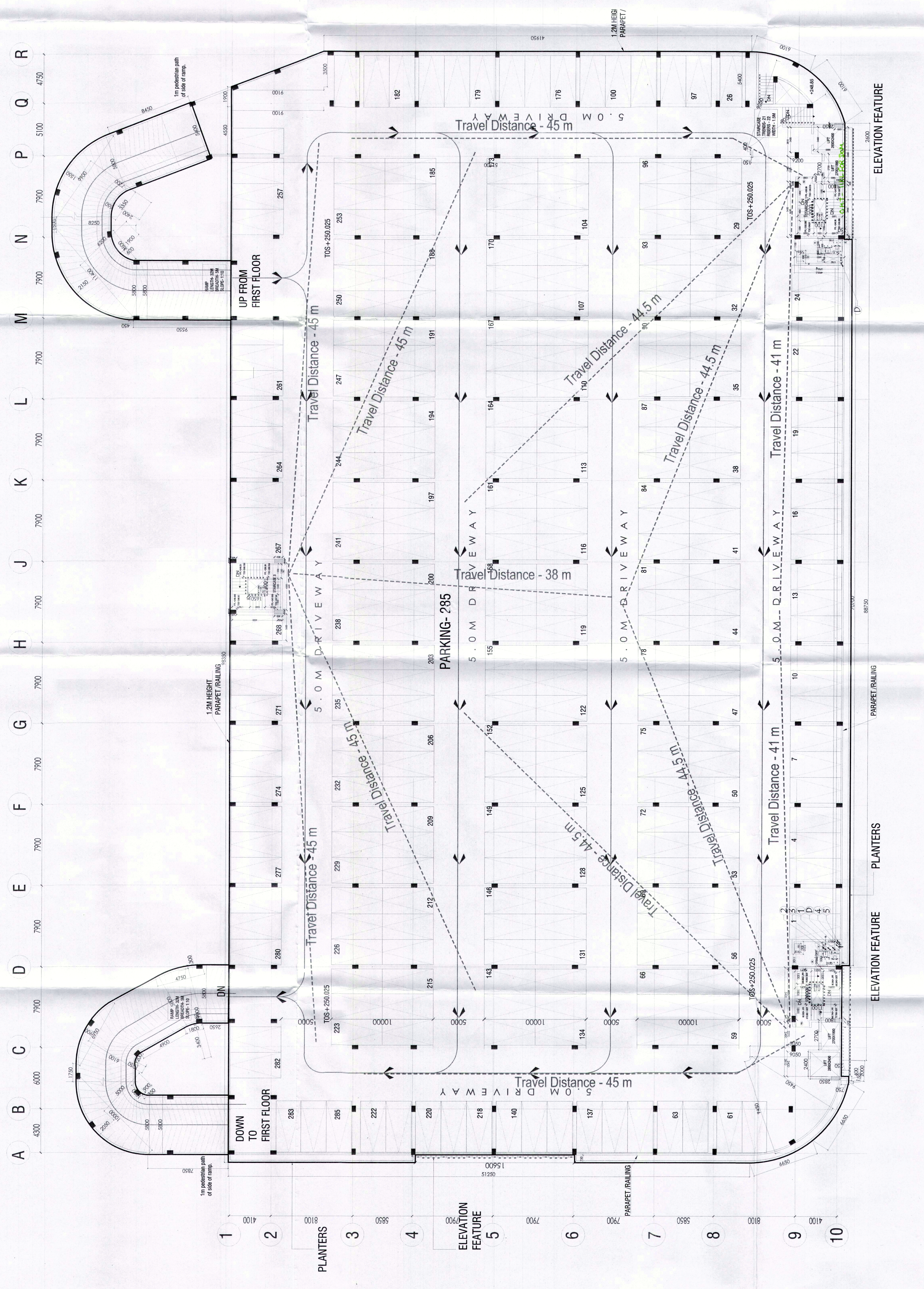

TERRACE | PARKING-285 FLOOR PLAN
 T.O.S. +250.025 | SCALE 1:150